

BUCK POINT RESORT

CALL FOR RESERVATIONS

1-320-859-2530

website: BuckPoint.com

E-MAIL: Fun@BuckPoint.com

21004 Fairfax Lane
Osakis, MN 56360

AMENITIES

- * 3 night minimum required
- * All prices subject to tax
- * Balance of rent on arrival
- * Guide available
- * Launching nearby
- * 2 fishing piers-lit all night - 88 ft.
- * Level ground-no hills or banks to climb
- * Play yard (Sand Box Area) with Rainbow PlaySystem
- * Unattended swimming beach
- * Chaise Lounges
- * Live bait & tackle
- * Dock side gas pump & oil
- * Fish cleaning house & freezers
- * One large fire ring for all to enjoy
- * Please bring your own towels
- * Gas B.B.Q. Grills for each cabin
- * Color TV's w/ satellite - Wireless Internet Service
- * Weeks run from Saturday to Saturday during summer season
- * Cement Basketball Area
- * Tables & chairs on decks
- * Cancellation Policy:
Should you find it necessary to cancel your reservation, please notify us immediately. A refund will be given less \$25 handling if we can fill your reservation on the same basis.
- * When we confirm a cabin for you, we refuse all other requests for it. In turn, guests are responsible for payment of the entire reservation fee.
- * Our business policy is intended to be fair to our guests, and yet, to prevent loss of income to our business.

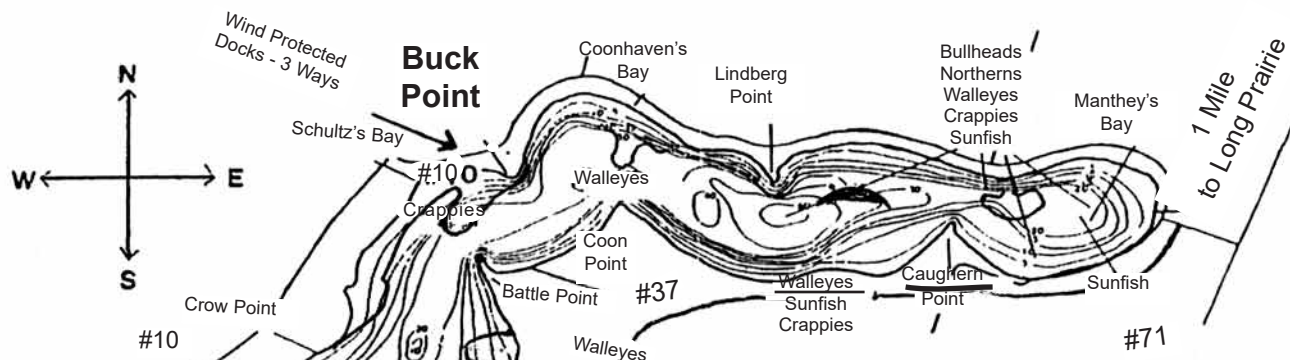

12 Spacious, Clean Cabins

Cabins 1-11 are furnished with full kitchens, bedding, heat showers - air conditioning - microwave, Color TV

Cabin 12 has full kitchen, including dishwasher bedding - heat - shower - air conditioning, microwave - color TV's - and your own lift & dock.

Plus a cabin boat if you need it
Cabin 12 No pets allowed
Bring your own towels

Lakeside cabins are 50 ft. from lake
Lodge & cabin #4 - 100 ft. from lake

5.5 Miles
to Osakis

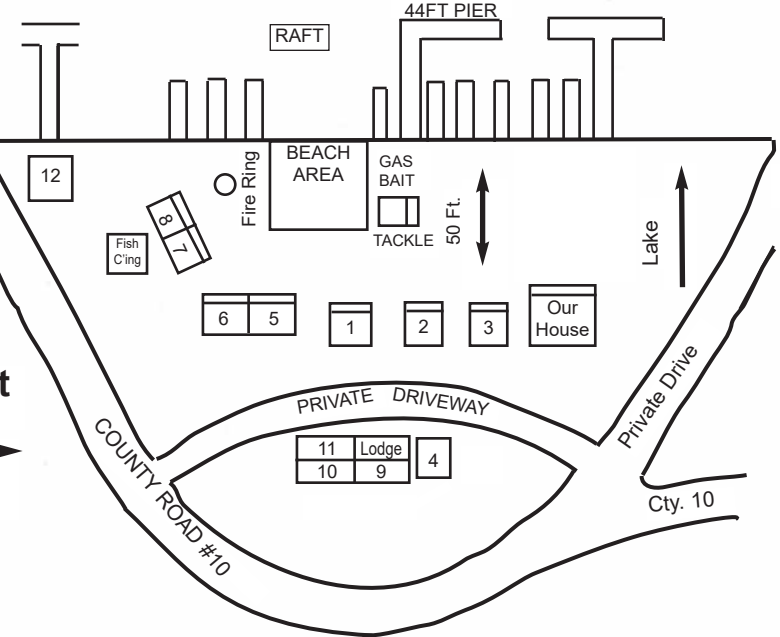
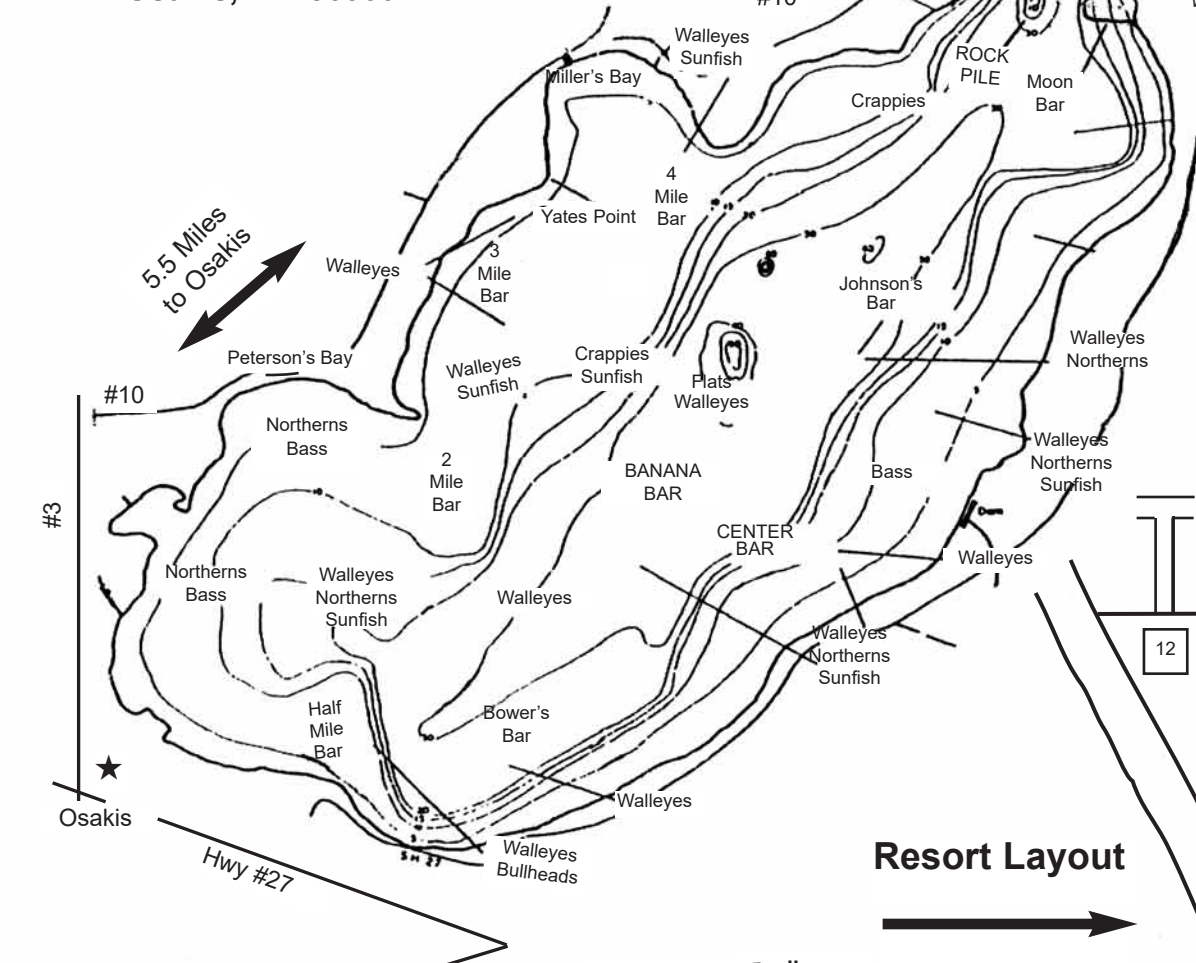

Alexandria - 12 miles I-94 Minneapolis - 125 miles

Resort Layout

2025 Equipment Rental

	Day	Week
Boats	\$25.00	\$100.00
15 h.p. Motors + Gas	\$75.00	\$425.00
Boat Docking	\$ 3.00	\$ 15.00
Some boat lifts are available-but are rarely needed		
Boat Lifts (Fishing boats only)		\$ 35.00
Fun Bugs	FREE	
Paddle Boats	FREE	
Horseshoes	FREE	
Basketball	FREE	
Swimming Raft	FREE	

Cabin Layouts

CABIN NO. 1

Knotty Pine
1 Queen Bed • 2 Double Beds • 3 Bedroom

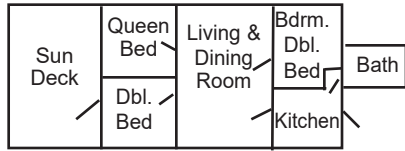

CABIN NO. 2

Knotty Pine
Wheelchair Access • 3 Double Beds

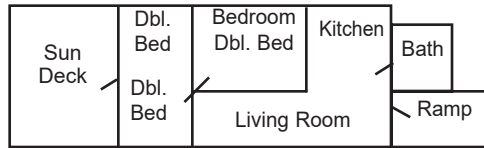

CABIN NO. 3

Knotty Pine
Total Electric • 2 Double Beds

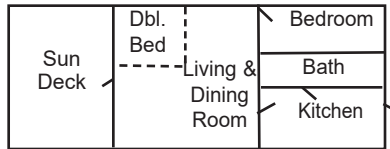

CABIN NO. 4

Knotty Pine
1 Queen Bed • 1 Double Bed • 2 Bedroom



CABIN NO. 5 & 6

Sleeps up to 2 people each

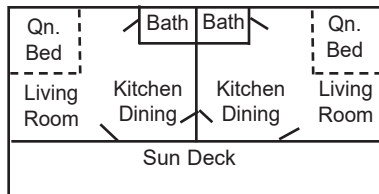

CABIN NO. 7 & 8

Knotty Pine
1 Queen Bed • 2 Double Beds

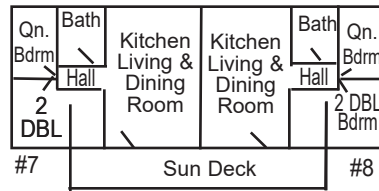

UNITS 9 & 10

4 Double Beds - 2 Bedrooms
Above Lodge
Total Electric

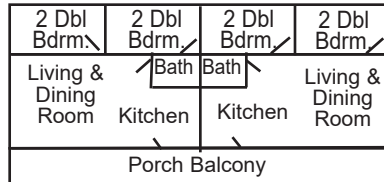

#9 #10

UNITS 11

1 Queen Bed
1 Double Bed
2 Bedrooms
Wheelchair Accessible
Lodge Ground Floor

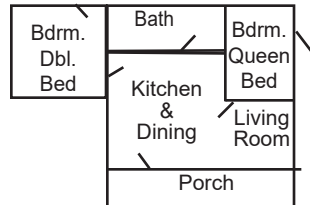

**SORRY
NO PETS**

UNIT NO. 12

**PRIVATE HOUSE
Lake Front**

Private
Dock & Lift

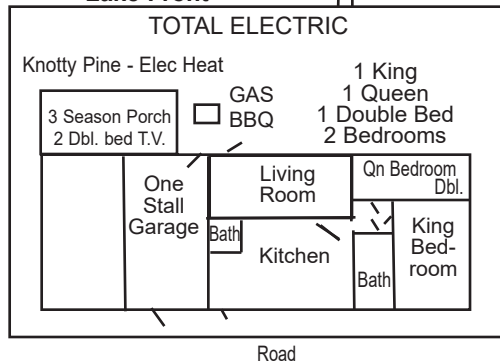

ALL CABINS ARE NON SMOKING

2025 BASE RATE		Spring & Fall May 10 - May 31 Aug. 16 - Oct. 18	Summer May 31 - Aug. 16 WEEKLY ONLY SAT. - SAT.
All cabins are furnished with full kitchens, bedding - heat - showers - air conditioned - microwaves - coffee maker Color T.V.'s with Satellite and Wireless Internet - bring your own towels			
Cabin 1 KNOTTY PINE	3 Bedroom 2 bedrooms w/double beds 1 bedroom w/Queen bed	4 people 1,100	6 people 1,350
Cabin 2 WHEELCHAIR ACCESSIBLE KNOTTY PINE	3 Double Beds 1 bedroom w/double bed 2nd bedroom w/2 double beds	4 people 1,100	6 people 1,350
Cabin 3 TOTAL ELECTRIC KNOTTY PINE	2 Double Beds 1 bedroom w/double bed 1 double bed in front room	2 people 900 4 people 975	4 people 1,175
Cabin 4 KNOTTY PINE	2 Bedroom 1 bedroom w/double bed 1 bedroom w/Queen bed	2 people 775 4 people 850	4 people 1,050
Cabin 5 or 6 Cabin 5 & 6 together	1 Queen Bed One room cabin w/bath Used as one 2 rooms/2 baths 2 Kitchens - 2 TV's	2 people 725 4 people 900	2 people 875 4 people 1,100
Cabin 7 or 8	1 Queen Bed 2 Double Beds 1 bedroom - 1 queen 2nd bedroom - 2 double	4 people 975	5 people 1,200
KNOTTY PINE			
Units 9 or 10 Above Lodge TOTAL ELECTRIC	2 Bedroom 4 Double Beds 1 bedroom w/2 double beds 2nd bedroom w/2 double beds	4 people 975	6 people 1,150
Unit 11 - Lodge	2 Bedroom Wheel Chair Accessible 1 bedroom w/Queen bed 2nd bedroom w/double bed Electric Heat	2 people 875 4 people 950	4 people 1,075
An All Modern 2 Bedroom Total Electric House Unit No. 12 Boat Lift SORRY NO PETS Dishwasher, 1 1/2 bath 3 Season Porch • Knotty Pine • 2 Double Beds • T.V. • Elec. Heat, Air Conditioning		4 people 1,200	6 people 1,550
<u>Over base rate per person \$25/day \$150/week</u> Deposit required - \$400.00 per week per cabin spring & fall Deposit required - \$500.00 per week per cabin summer Deposit required - \$600 for cabin 12		Day guest charge \$10.00 per person per day. *Guests must register at Lodge.* We reserve the right to limit	
CABIN NIGHTLY RATES - Spring & Fall Only (Cabins: 3, 4, 7, 8, 9, 10, 11) Cabin 4 & 11 \$160 per night Friday, Saturday, or Sunday - Party of 4 Cabin 4 & 11 \$140 per night Monday-Thursday - Party of 4 Cabin 3, 7, 8, 9, 10 \$170 per night Friday, Saturday, or Sunday - Party of 4 Cabin 3, 7, 8, 9, 10 \$150 per night Monday-Thursday - Party of 4 Cabin 5 & 6 Together 4 people \$160 per night Cabin #5 or 6 - Party of 2 - Monday-Thursday, \$125 per night Friday, Saturday, or Sunday - \$135 per night Cabin #1 & 2 Party of 4 - Friday, Saturday, Sunday - \$200 Mon.-Thurs. - \$175 Cabins #1-11 (3 night minimum) Cabin #12 Party of 4 - \$250 per night with (4 night minimum) \$10 Charge for Boat Launching • All Cabin rates subject to tax		SMALL PETS (Under 25 lbs.): ARE ALLOWED ONLY WITH THE PERMISSION OF MANAGEMENT \$100 per week - \$20 a day MUST BE QUIET - LEASHED AT ALL TIMES AND CLEANED UP IMMEDIATELY AFTER	
		Check in 4:00 p.m. Check out 9:00 a.m. Discover, Visa and MasterCard accepted A 2% fee will be applied on all credit card purchases	